

Spotlight Cooler 34W Flush Mount LED Heat Sink

This LED Heatsink is part of the Aavid scalable LED portfolio.

Future proof – Designed with the rapidly evolving light engine industry in mind, thermal performance can be easily increased or decreased without a luminaire redesign by adding or removing a SynJet Cooler

Flexibility – Configure to order luminaire production process, use heatsinks for low lumen applications and the SynJet Cooler with heatsink for higher lumen versions

Freedom – Compatible with most major light engines so thermal solutions and mechanical interfaces do not have to be redesigned when changing light engines

Fast – In stock and ready for overnight delivery, worldwide



Specifications

Thermal¹

Thermal Wattage	Heatsink Θ_{s-a} ²	Heat Sink $T_{\text{Rise Above Ambient}}$
10 W	2.8 (°C/W)	28 (°C)
15 W	2.5 (°C/W)	37 (°C)
20 W	2.4 (°C/W)	47 (°C)

Mechanical

Material	6063-T5 Al Extrusion
Finish	Black Anodized
Weight	214g
Regulatory	RoHS

Size
Diameter: 87 mm
Height: 57 mm

The chart below summarizes the thermal performance of all round LED heatsink solutions with diameters from 75 to 100 mm.

¹ All values are typical at 25°C unless otherwise stated.

² Thermal resistance values are given as reference only and are measured in free air without airflow obstructions. Thermal resistance is measured from the bottom middle of the heat sink to ambient air, with a heat source of 19 cm². Actual thermal performance may vary by application and final product design should be tested to assure proper thermal performance.

**Heatsink Rise Above Ambient vs. Thermal Power
Round Heatsinks Diameter 75 to 100 mm**

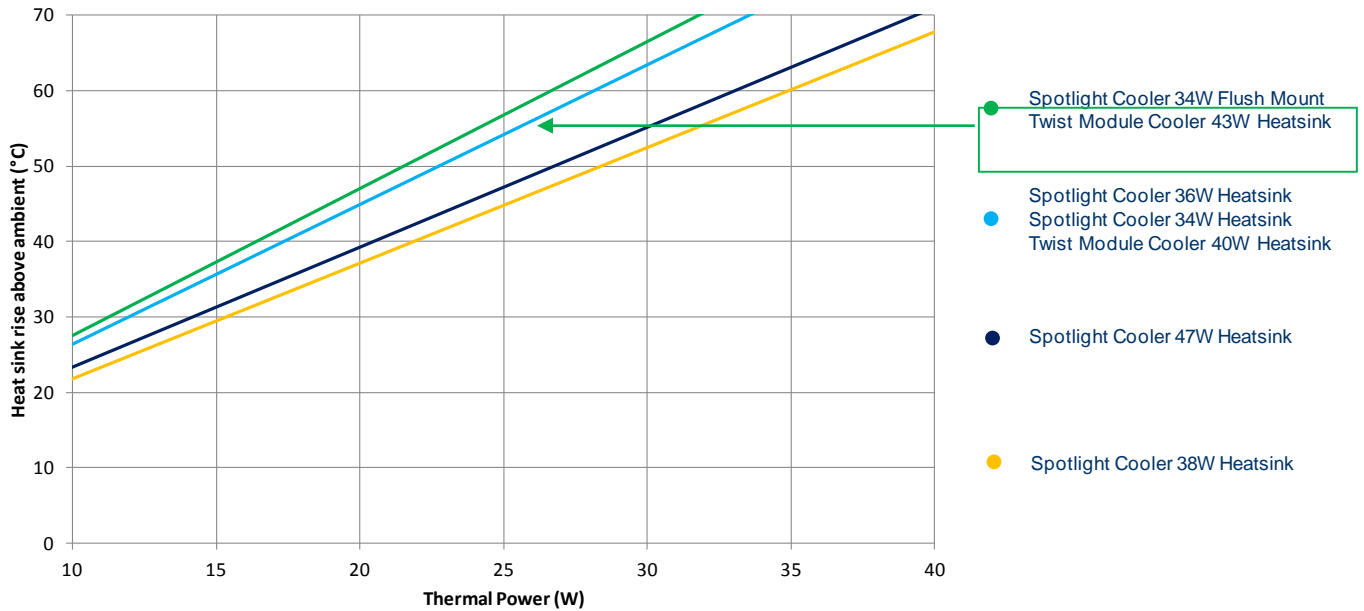

Mechanical – LED heat sink (Configurable version shown)

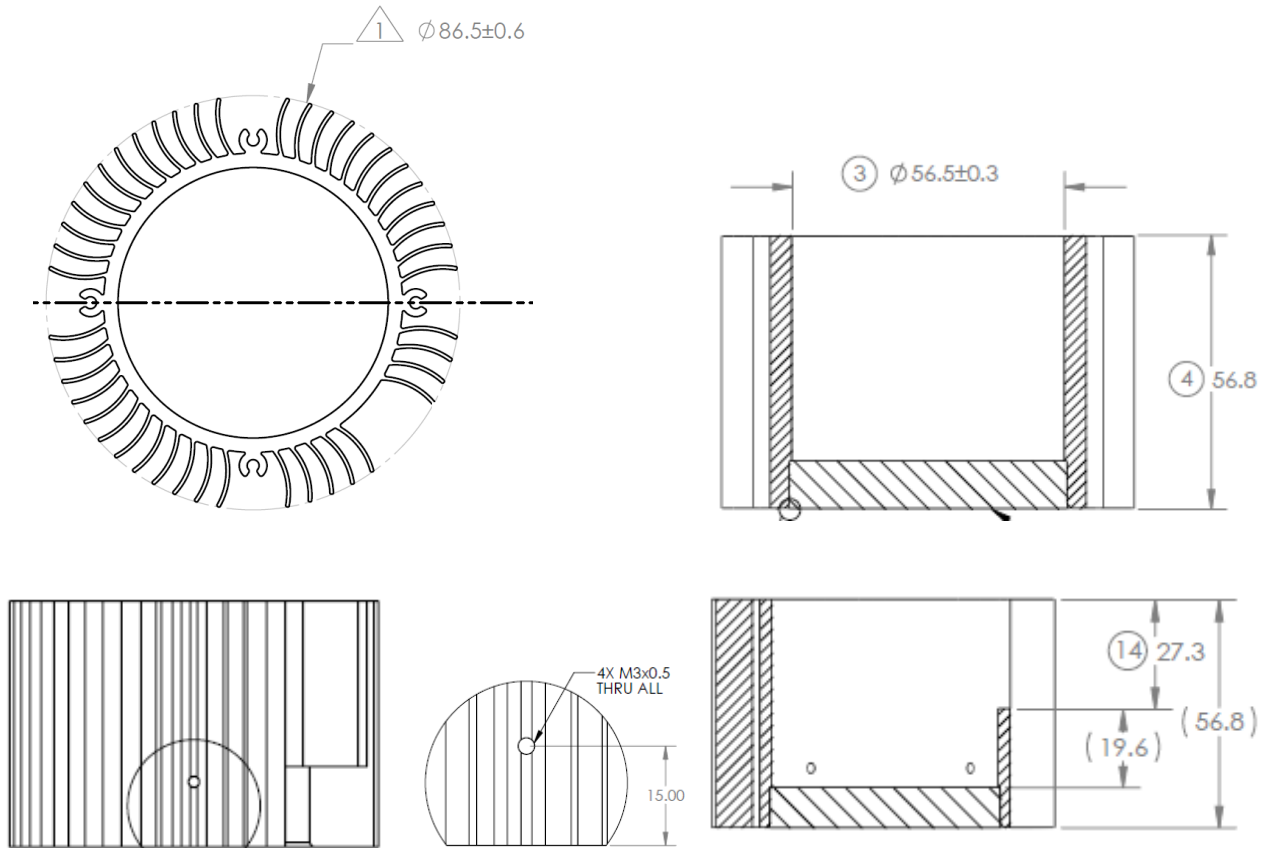

All dimensions are nominal and in mm unless otherwise stated. See product drawings for more detail.

Part Numbers

Part Number	Description	Notes
HSLCS-CALBL-020	Heatsink, 34W, Spotlight Cooler, Flush Mount, Philips SLM, Vossloh-Schwabe, Black	Mounting holes for Philips SLM or Vossloh-Schwabe
HSLCS-CALBL-021	Heatsink, 34W, Spotlight Cooler, Flush Mount, Osram PrevaLED, Black	Mounting holes for Osram PrevaLED
HSLCS-CALBL-022	Heatsink, 34W, Spotlight Cooler, Flush Mount, Configurable, Black	Mounting surface does not have mounting holes
HSLCS-CALBL-023	Heatsink, 34W, Spotlight Cooler, Flush Mount, Bridgelux ES, Black	Mounting holes for Bridgelux ES
HSLCS-CALBL-024	Heatsink, 34W, Spotlight Cooler, Flush Mount, Xicato XSM, Black	Mounting holes for Xicato XSM
HSLCS-CALBL-025	Heatsink, 34W, Spotlight Cooler, Flush Mount, Zhaga B3, Black	Mounting holes for Zhaga Standard
HSLCS-CALBL-027	Heatsink, 34W, Spotlight Cooler, Flush Mount, Lumileds Luxeon K, Black	Mounting holes for Luxeon K 8-24 die
HSLCS-CALBL-028	Heatsink, 34W, Spotlight Cooler, Flush Mount, Osram Soleriq, Ledil, Black	Mounting holes for Soleriq E30&45and Ledil
HSLCS-CALBL-031	Heatsink, 34W, Spotlight Cooler, Flush Mount, Xicato XSM M3, Black	Mounting holes for Xicato XSM
HSLCS-CALBL-034	Heatsink, 34W, Spotlight Cooler, Flush Mount, Bridgelux Vero 13/18, ES, Molex, Black	Mounting holes for Bridgelux Vero, and ES

Aavid reserves the right to make changes to the products or information contained herein without notice. No liability is assumed as a result of their use or applications. For additional information, please contact Aavid directly.